

NOTICE: DRAWING APPROVALS, SPECIFICATIONS, OR OTHER DATA ARE USED FOR ANY PURPOSE OTHER THAN TO SERVICE THE MILITARY OR NAVAL ESTABLISHMENTS. THE UNITED STATES GOVERNMENT ACCEPTS NO RESPONSIBILITY AND MAKES NO WARRANTY, EXPRESS OR IMPLIED, AS TO THE ACCURACY, COMPLETENESS, OR USE OF THE INFORMATION CONTAINED HEREIN. THE USER SHALL BE RESPONSIBLE FOR OBTAINING NECESSARY PERMISSIONS FROM THE APPLICABLE AGENCIES FOR REPRODUCTION OR TRANSMISSION OF THIS DATA IN ANY FORM OR BY ANY MEANS, ELECTRONIC OR MECHANICAL, INCLUDING PHOTOCOPYING, RECORDING, OR BY ANY INFORMATION STORAGE AND RETRIEVAL SYSTEM. THIS DOCUMENT IS UNCLASSIFIED.

THIS DOCUMENT HAS BEEN REPRODUCED BY THE GOVERNMENT AND MAY BE REPRODUCED AND USED IN CONNECTION WITH ANY GOVERNMENT PROCUREMENT OR MAINTENANCE OPERATION.

NOTE: *FOR INFORMATION ONLY. CONTRACTOR MAY AT HIS OPTION DEVIATE FROM THESE PROCESS DETAILS

X SWE APPROVAL		REVISIONS			
SYM	PP	SYN	DESCRIPTION	DATE	APPROVAL
	10042716	A	SEE SHEET 1 FOR REVISIONS	DEC 59	FILE
B	C.A.# 84875	B	(1) ADDED PART NO. (SM-D-249143) TO SILK SCREEN. (2) SM-D-248776 WAS SM-D-249143	OCT 60	FILE
		C	(1) ADDED SEE NOTE 4. (2) SEE SHEET 1 FOR REVISION		FILE

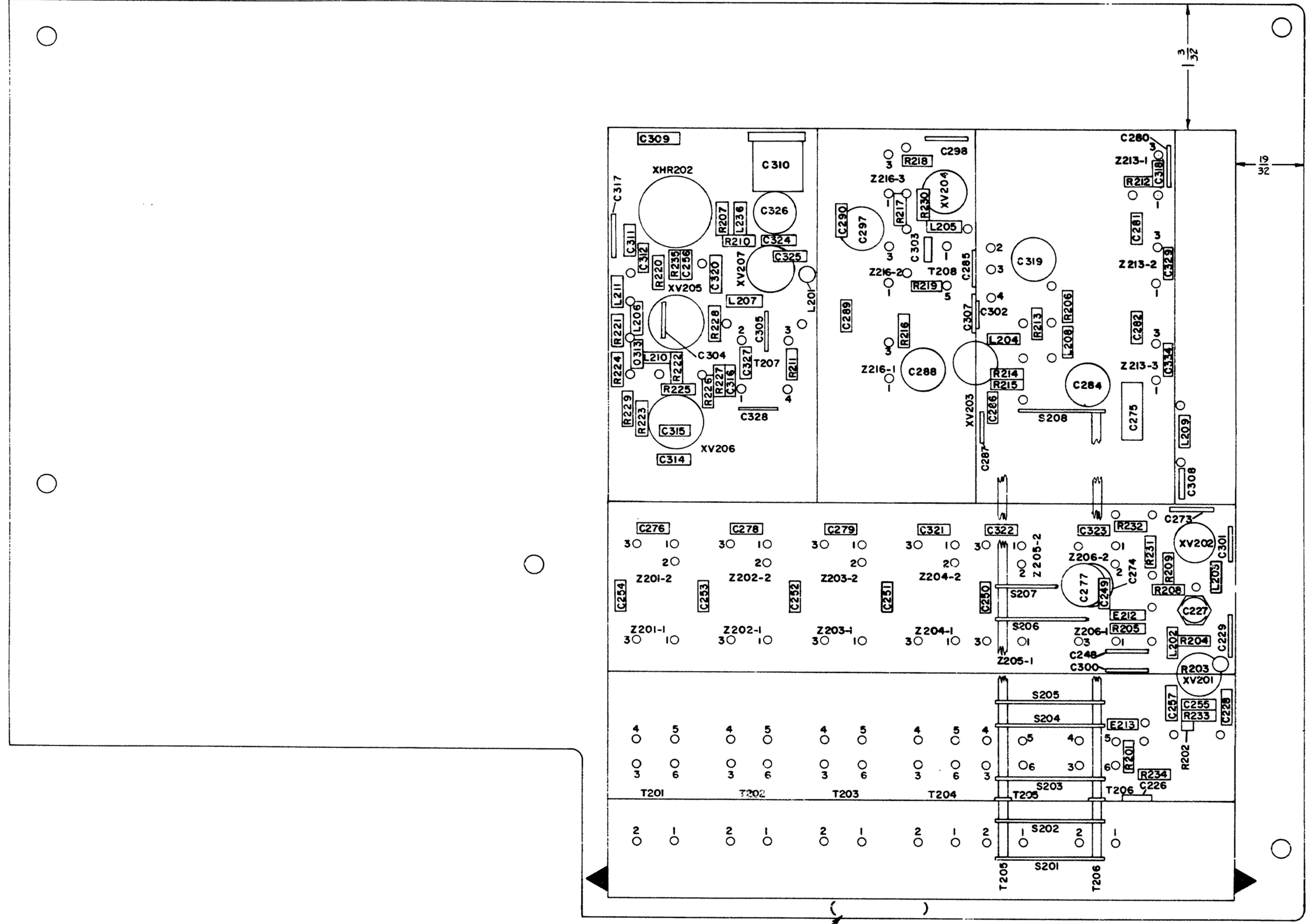

(B)
SEE NOTE 4.
(C)

RECD	PART NO.	DESCRIPTION	MATL	MATL SPEC
LIST OF MATERIAL				
DEPARTMENT OF THE ARMY SIGNAL CORPS ENGINEERING LABORATORIES FORT MONMOUTH NEW JERSEY				
COVER, R.F. SM-D-249143 Sheet 2				

UNLESS OTHERWISE SPECIFIED	
DIMENSIONS ARE IN INCHES	
TOLERANCES ON FRACTIONS DECIMALS ANGLES	
± 1/64 ± .005 ± 1°	
SM-D-343622	Drawn By: HENRY
SM-D-248776 SC-DL-248775	Checked By: [Signature]
NEXT ASSY	USED ON
APPLICATION	Eng Approval

COLLING RATIO	REVIEWED	APPROVED	DATE	SCALE
14214-PH-3-93 <td>PME <td>HLV <td>29 DEC 55 <td>2/1 </td></td></td></td>	PME <td>HLV <td>29 DEC 55 <td>2/1 </td></td></td>	HLV <td>29 DEC 55 <td>2/1 </td></td>	29 DEC 55 <td>2/1 </td>	2/1

NOTICE: DRAWING APPROVED FOR CONSTRUCTION, BUT THIS DRAWING IS NOT TO BE USED FOR CONSTRUCTION UNLESS IT IS APPROVED BY THE CONTRACTOR. THE CONTRACTOR SHALL BE RESPONSIBLE FOR OBTAINING ALL NECESSARY PERMITS AND APPROVALS FROM THE APPROPRIATE AGENCIES. THE CONTRACTOR SHALL BE RESPONSIBLE FOR OBTAINING ALL NECESSARY PERMITS AND APPROVALS FROM THE APPROPRIATE AGENCIES. THE CONTRACTOR SHALL BE RESPONSIBLE FOR OBTAINING ALL NECESSARY PERMITS AND APPROVALS FROM THE APPROPRIATE AGENCIES.

"THIS DOCUMENT" HAS BEEN REPRODUCED BY THE GOVERNMENT AND IS NOT TO BE REPRODUCED OR TRANSMITTED IN ANY FORM OR BY ANY MEANS, ELECTRONIC OR MECHANICAL, INCLUDING PHOTOCOPYING, RECORDING, OR BY ANY INFORMATION STORAGE AND RETRIEVAL SYSTEM, WITHOUT PERMISSION IN WRITING FROM THE GOVERNMENT.

NOTE: *FOR INFORMATION ONLY. CONTRACTOR MAY AT HIS OPTION DEVIATE FROM THESE PROCESS DETAILS

XSW APPROVAL		REVISIONS		
SYM	DESCRIPTION	DATE	APPROVAL	
A	SEE SHEET 1 FOR REVISIONS	1959	11223-PL-39 -AL-51 PME	
B	SEE SHEET #2 FOR REVISIONS	24 OCT 60	42428-PC-53 PME	
C	SEE SHET 1 & 2 FOR REVISIONS		42428-PC-53 PME	

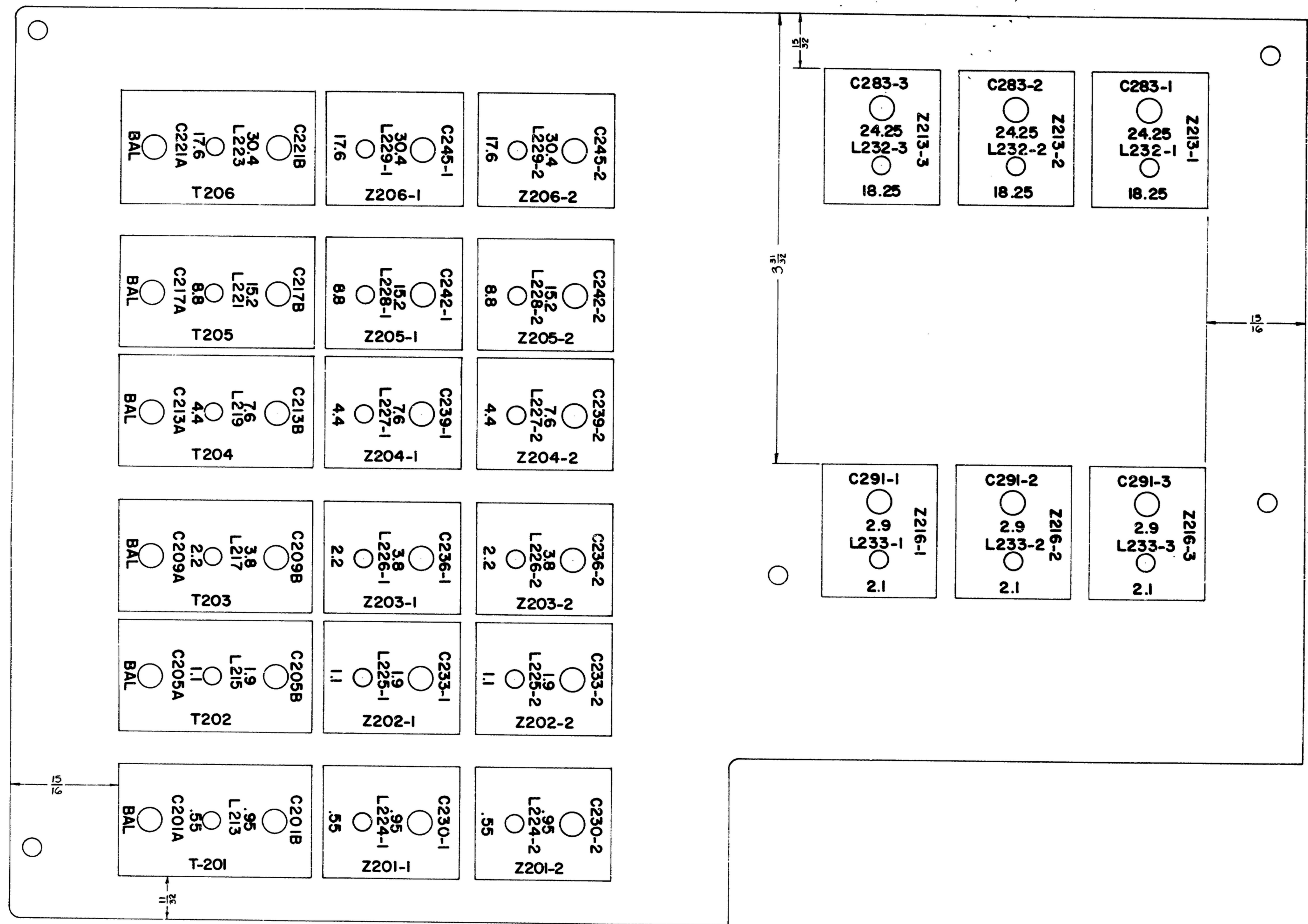

RFQD	PART NO.	DESCRIPTION	MAT.	MATL SPEC
LIST OF MATERIAL				
		COVER, R.F.		
		DEPARTMENT OF THE ARMY SIGNAL CORPS ENGINEERING LABORATORIES FORT MONMOUTH NEW JERSEY		
		SM-D-249143 Sheet 3		

UNLESS OTHERWISE SPECIFIED DIMENSIONS ARE IN INCHES TOLERANCES ON FRACTIONS DECIMALS ANGLES ± 1/4 ± .005 ± 1°	DRAWN BY HENRY CHECKED BY [Signature] DATE 29 DEC 55
SW-D-343622 SM-D-248776 SC-DL-248775 NEXT ASSY USED ON	APPLICATION DATE 29 DEC 55

WHEN REFERRING TO THIS DRAWING STATE DRAWING NO., APPLICABLE ISSUE SYMBOL, IF ANY, AND DATE.